

# The Big John Commode Chair



**Model# BJBC**  
**700lb. capacity**

**Bedside or  
over toilets**

Commode liner & absorbent pads available separately

## Installation Instructions

- 1- Attach cross frame to arms with clips, making sure clips are fully inserted into the frame. Make sure the mounting plate is facing up and at the rear of the chair, where the back rest will attach.
- 2- Attach legs to arm frame by depressing push pins and sliding legs over arm ends and aligning buttons with holes in the legs. Make sure the legs are aligned to the same height and they are locked in place by pushing or pulling them to make sure they don't move.
- 3- Attach back rest with bolts, wave washers, & butterfly nuts. Make sure the wave washer is face down and flat on the frame.
- 4- Attach the seat to the mounting plate using the attached seat hardware. Please note that the hinges and caps are labeled (L) & (R), which refer to their position when you are facing the chair.
  1. Insert screws into plastic hinges.
  2. Insert the left and right hinges through the corresponding side of toilet seat and lid.
  3. Locate the rubber washers over the holes on the support bracket on the rear crossbar.
  4. Mount the toilet seat by locating two hinges through the holes in the bracket.
  5. Screw the wing-nuts on to the bolts making sure they are tight.
- 5- Make sure all connections are tight.
- 6- Insert bucket if desired. Handle should be out of the way of the seat. Bucket is for use when chair is not used over a toilet.
- 7- Check regularly to make sure all connections are secure and all components are in good condition. Do not use if any component is damaged.

### Step 1



### Step 2



### Step 3

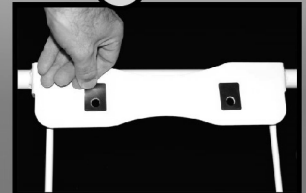

### Step 4



### Step 5

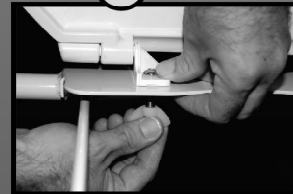

1. Test for stability before use.
2. The product is designed for use in a static mode only. As with all devices designed to assist the elderly or disabled, care should be taken to avoid sudden or undue movement during use.
3. Clean with mild, household cleaning products. Do not use abrasive powders or scouring pads.

Design and specification are subject to changes without prior notice.

**TOLL FREE: 866-366-0669**

Big John Products 8533 Canoga Ave. Suite D, Canoga Park, CA 91304

**www.bigjohnproducts.com**

# The Big John Commode Chair



**Model# BJBC**  
**700lb. capacity**

**Bedside or  
over toilets**

Commode liner & absorbent  
pads available separately

## Warning:

1. Toilet seat must be down before use. Failure to do so may result in damage to commode chair or injury.
2. DO NOT assemble or use the commode chair if you do not understand these instructions.
3. Inspect all parts prior to assembly or use. If the commode chair arrives damaged, please notify delivery driver and contact the dealer that you purchased the commode chair from. DO NOT USE.
4. Make sure all buttons fully protrude through the corresponding holes in the legs and that all legs are the same height and the commode chair is level and that all four legs touch the floor at the same time
5. Make sure all clips, snaps and bolts / nuts are tight.
6. Before use, check to make sure the rubber tips on the legs are in good condition. If they are damaged, DO NOT USE.
7. Users with limited strength and mobility should be supervised or assisted while using the commode chair.

## Commode Chair Parts List



2 - Arms with Arm Rests

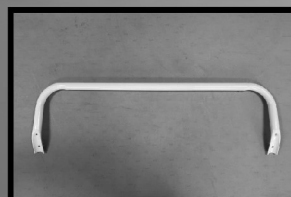

1 - Backrest

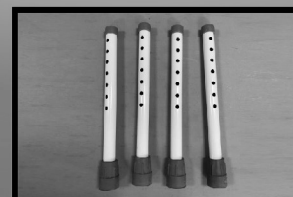

4 - Legs

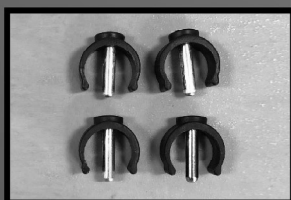

4 - Clips

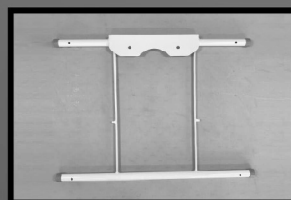

1 - Cross Frame



2 - Bolts



2 - Wave Washers

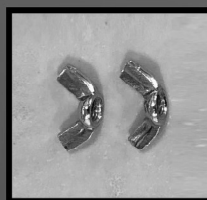

2 - Butterfly Nuts

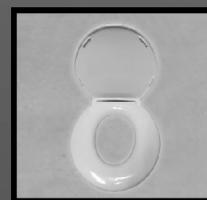

1 - toilet Seat



1 - Bucket

**TOLL FREE: 866-366-0669**

Big John Products 8533 Canoga Ave. Suite D, Canoga Park, CA 91304

**www.bigjohnproducts.com**